



'O' CLIPS FROM JUBILEE®

Jubilee 'O' Clip 2-Ear clamps are widely used for maintenance and OEM applications. Mainly used on air, fluid, gas and steam lines and also suitable for low pressure hydraulic applications.

The absence of a screw mechanism allows Jubilee® 'O' Clips to be useful on extremely small hoses. The tamper proof nature of the fitting may also make the Jubilee® 'O' Clips suitable for certain applications where there may be a risk associated with any interference to the fitting. Sometimes affectionately referred to as "Lemon Clips" due to their shape and also referred to as double ear clips and 2-ear clips.

Pincers (both normal closing and side closing) are used to crimp the ears of the clamps and affect a proper seal.

2-ear clamps are best installed by closing one ear fully first, the second ear is then closed so that the first ear opens slightly (gap to be approximately 1.5mm). This builds a resilient strength into the clamp in a spring-like action to hold against pressure, vibration and hose shrinkage due to temperature changes or ageing.

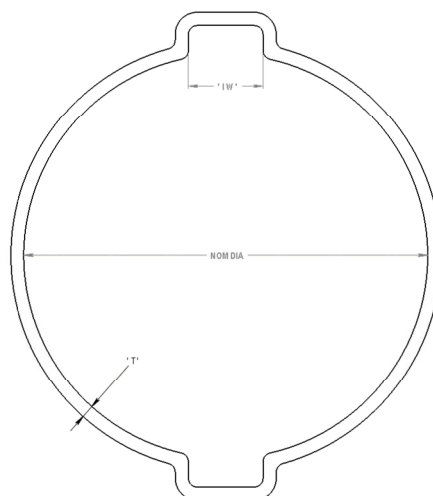
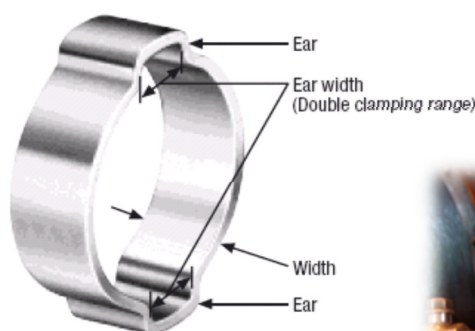

Position clip on hose, crimp one ear fully first before firmly squeezing the other ear.

Use side closing pincers where access to ear is difficult.



To remove a clamp, place the pincer jaws across the ear and cut through it.

Available in:-

Mild Steel Zinc Plated

304 Stainless Steel

'O' CLIPS

Mild Steel Zinc Plated:-

Part No.	Adjustment mm	Band Width mm	Band Thickness mm	Maximum Pressure PSI	Part No.
OC0305MS	3-5	5.0	0.7	200	OC0305MS
OC0507MS	5-7	6.0	0.7	200	OC0507MS
OC0709MS	7-9	7.0	1.0	200	OC0709MS
OC0811MS	8-11	7.0	1.0	200	OC0811MS
OC0911MS	9-11	7.0	1.0	200	OC0911MS
OC1113MS	11-13	7.0	1.0	200	OC1113MS
OC1315MS	13-15	7.5	1.0	200	OC1315MS
OC1517MS	15-17	8.0	1.2	200	OC1517MS
OC1518MS	15-18	8.0	1.2	200	OC1518MS
OC1619MS	16-19	8.0	1.2	200	OC1619MS
OC1720MS	17-20	8.5	1.2	200	OC1720MS
OC1922MS	19-22	9.0	1.5	180	OC1922MS
OC2023MS	20-23	9.0	1.5	180	OC2023MS
OC2225MS	22-25	10.0	1.5	180	OC2225MS
OC2327MS	23-27	10.0	1.5	180	OC2327MS
OC2528MS	25-28	10.0	1.5	180	OC2528MS
OC2731MS	27-31	10.0	1.5	180	OC2731MS
OC2831MS	28-31	10.0	1.5	180	OC2831MS
OC3134MS	31-34	10.0	1.5	75	OC3134MS
OC3437MS	34-37	10.0	1.5	75	OC3437MS
OC3740MS	37-40	10.0	1.5	75	OC3740MS
OC4043MS	40-43	10.0	1.5	75	OC4043MS
OC4346MS	43-46	10.0	1.5	75	OC4346MS

Corrosion Resistance: 72 hours NSS Test

Fastening: Pinch

Industry Recommendations:-

Quality Assurance:-



Mild Steel Zinc Plated



'O' CLIPS

304 Stainless Steel:-

Part No.	Adjustment mm	Band Width mm	Band Thickness mm	Maximum Pressure PSI	Part No.
OC0305SS	3-5	5.0	0.7	200	OC0305SS
OC0507SS	5-7	6.0	0.7	200	OC0507SS
OC0709SS	7-9	7.0	1.0	200	OC0709SS
OC0911SS	9-11	7.0	1.0	200	OC0911SS
OC1113SS	11-13	7.0	1.0	200	OC1113SS
OC1315SS	13-15	7.5	1.0	200	OC1315SS
OC1517SS	15-17	8.0	1.2	200	OC1517SS
OC1518SS	15-18	8.0	1.2	200	OC1518SS
OC1720SS	17-20	8.5	1.2	200	OC1720SS
OC1922SS	19-22	9.0	1.5	180	OC1922SS
OC2023SS	20-23	9.0	1.5	180	OC2023SS
OC2225SS	22-25	10.0	1.5	180	OC2225SS
OC2327SS	23-27	10.0	1.5	180	OC2327SS
OC2528SS	25-28	10.0	1.5	180	OC2528SS
OC2731SS	27-31	10.0	1.5	180	OC2731SS
OC2831SS	28-31	10.0	1.5	180	OC2831SS
OC3134SS	31-34	10.0	1.5	75	OC3134SS
OC3437SS	34-37	10.0	1.5	75	OC3437SS
OC3740SS	37-40	10.0	1.5	75	OC3740SS
OC4043SS	40-43	10.0	1.5	75	OC4043SS
OC4346SS	43-46	10.0	1.5	75	OC4346SS

Corrosion Resistance: 1000 hours NSS Test

Fastening: Pinch

Industry Recommendations:-

Quality Assurance:-



304 Stainless Steel



The finest hose clip in the world